

CADLink

Real time BOM comparison, 2-way data push
Payback period of 6 months

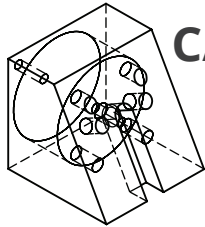

CAD



ORACLE®

No	Save	Short Identifier	Part Number	Branch	Revision	Description	Unit Qty	UCOM	Stocking Type	MI Part Number	MI Part Description	MI Inventory U
1.1	<input checked="" type="checkbox"/>	744190	CRT-00112ASM	M10	A	Mechanical Advance Assembly	1.0000	EA	S			
1.1.1	<input checked="" type="checkbox"/>	744149	AL-00132ASM	M10	A	Advance Latch Assembly	1.0000	EA	S			
1.1	<input checked="" type="checkbox"/>	744211	AL-400291	M10	A	Advance Latch, 4 Digit	1.0000	EA	S			
1.1	<input checked="" type="checkbox"/>	744195	SS-00012834	M10	A	Spring, Steel Material 12834	1.0000	EA	S			
1.1.2	<input checked="" type="checkbox"/>	744229	ALH-08123ASM	M10	A	Advance Latch Housing Assembly	1.0000	EA	S			
1.1	<input checked="" type="checkbox"/>	0	ASS-029311	M10	A	Advance Spring Stud Black	2.0000	EA	S			
1.1	<input checked="" type="checkbox"/>	744114	AL-192312	M10		Advance Latch Shaft, Steel Mat	1.0000	EA	S			
1.1	<input checked="" type="checkbox"/>	744095	ALH-4002817	M10		Advance Latch Housing 4 Digit	1.0000	EA	S			
1.1	<input checked="" type="checkbox"/>	744093	AP-0028434	M10	A	Advance Pin, Steel Material 28	1.0000	EA	S			
1.1	<input checked="" type="checkbox"/>	744108	RB-0978078	M10		Reset Bearing	1.0000	EA	S			
1.2	<input checked="" type="checkbox"/>	744237	CR-39102ASM	M10	A	Counter Reset Assembly TEST	1.0000	EA	S			
1.2.1	<input checked="" type="checkbox"/>	744291	TAVQB-L5-82384	M10	A	Reset Latch Shaft	1.0000	EA	S			
1.2.2	<input checked="" type="checkbox"/>	0	TAVQB-L-0001	M10	A	Latch Product	4.0000	EA	S			
1.2.3	<input checked="" type="checkbox"/>	744253	RS-0018234	M10	A	Reset Spring, Steel Material	4.0000	EA	S			
1.2.4	<input checked="" type="checkbox"/>	749013	RS-0018234A	M10		Reset Spring, Steel Material 1	4.0000	EA	S			
1.2.5	<input checked="" type="checkbox"/>	749054	LATCH 2	M10		Latch Steel Material 2345	4.0000	EA	S			
1.3	<input checked="" type="checkbox"/>	744333	NW-012145M	M10	A	Numbering Wheel 4 Digits Assem	1.0000	EA	S			
1.3.1	<input checked="" type="checkbox"/>	744394	RP-0001789	M10		Reset Pin, Material 1789	1.0000	EA	S			
1.3.2	<input checked="" type="checkbox"/>	744392	NW-4-8975	M10		Numbering Wheel Counter	1.0000	EA	S			
1.3.3	<input checked="" type="checkbox"/>	0	AL-192099	M10		Advance Latch Cam	4.0000	EA	S			
1.3.4	<input checked="" type="checkbox"/>	744350	PA-0001389	M10		Pin, Material 1389	2.0000	EA	S			
1.3.6	<input checked="" type="checkbox"/>	744368	NWS-029312	M10		Numbering Wheel Shaft	1.0000	EA	S			
1.3.8	<input checked="" type="checkbox"/>	744378	RVG-18920	M10		Reset Worm Gear	1.0000	EA	S			
1.3.7	<input checked="" type="checkbox"/>	748001	THREAD BLOCK 7	M10		Advance Latch	0.0004	EA	P			
1.4	<input checked="" type="checkbox"/>	744288	NW-1782ASM	M10	A	Numbering Wheel Housing Assemb	1.0000	EA	S			
1.4.1	<input checked="" type="checkbox"/>	744317	SB-0293121	M10		Print Head Spring Bracket, Mat	1.0000	DL	S			
1.4.2	<input checked="" type="checkbox"/>	0	ASS-029311	M10	A	Advance Spring Stud Black	2.0000	EA	S			
1.4.3	<input checked="" type="checkbox"/>	0	200604-000	M10	A	ASSEMBLY, BREAKER, IT-4B INPU	1.0000	EA	S			
1.4.4	<input checked="" type="checkbox"/>	744296	MCH-4M00932	M10		4 Digit Mechanical Counter Hou	1.0000	DW	S			
1.4.5	<input checked="" type="checkbox"/>	744309	CH-0219200	M10		Cartridge Heater	4.0000	DW	S			
1.4.6	<input checked="" type="checkbox"/>	744326	RS-000928	M10		Reset Speaker-STEEL	0.0001	SK	S			
1.5	<input checked="" type="checkbox"/>	744270	AS-019200	M10		Counter Advance Spring TEST	2.0000	DZ	S			
1.8	<input checked="" type="checkbox"/>	748072	CR-39102ASM	M10	A	Counter Reset Assembly TEST	0.0001	EA	S			

Features

- Real-time, direct, two-way link with Oracle
- Automated, single-step BOM push
- View BOM change summary
- Push Revision to Oracle and CAD
- Export Excel and PDF files
- Notification for errors and missing fields

Benefits

- Eliminate manual data entry
- Cut design cost
- Improve data consistency
- Improve information flow
- Increase data accuracy
- Reduce cycle time

+1 905 479 7811 | info@QBuildSoftware.com | +1 905 479 2636

www.QBuildSoftware.com

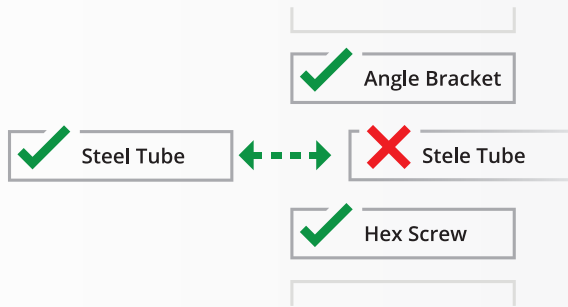

Resolve Discrepancies

Discrepancies between CAD and Oracle are highlighted, allowing you to select or enter the correct data.



Access Oracle Data

CADLink's direct integration allows you to access Oracle data such as Product Code, Part Class, and Raw Material Part Data from the CADLink interface.

Operations module available!

Assigning Oracle Operations can be easy! Simply select a work center from a drop-down list.

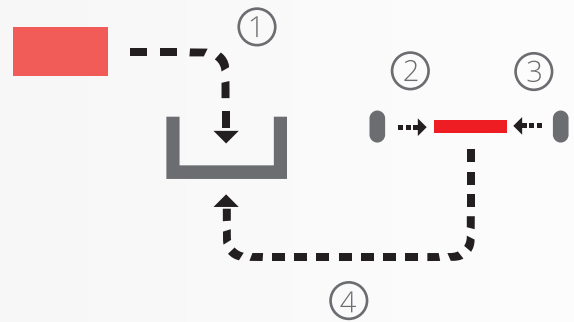

Partners & Integrations

