

CADLink

Real time BOM comparison, 2-way data push
Payback period of 6 months

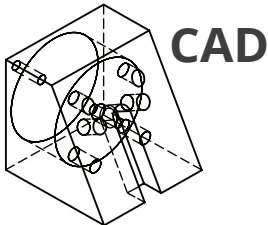

No.	SAVE	BCMD	Item Number	Revision	Item Name	Search	Source	BOM Q1	Unit	QtySeq	Product	Product	Product	Product	Item Gr	Model G	Storage	Trackin	SITE	WAREH	Mtl Item Number
1	<input checked="" type="checkbox"/>	000254	QB-BEZ_001	A	Bezel Moldbase			1.00	ea	0	Item	BOM	Product	REV	Audio	Standar	Site	None	Home s		
1.1	<input checked="" type="checkbox"/>		QB-BEZ_004	A	Bezel Moldbase Litter			2.00	ea	0	Item	BOM	Product		Audio	Standar	Site	None	Home s		
1.1.1	<input checked="" type="checkbox"/>		QB-BEZ_005		Unifiter U-Coupling			1.00	ea	0	Item	None	Product		Audio	Standar	Site	None	Home s		
1.2	<input checked="" type="checkbox"/>	000266	QB-BEZ_002	A	Bezel Moldbase - Fixed Half			1.00	ea	0	Item	BOM	Product	REV	Audio	Standar	Site	None	Home s		
1.2.1	<input checked="" type="checkbox"/>		RB-HASCO-03		HASCO Metric Angle Pin			4.00	ea	0	Item	None	Product		Audio	Standar	Site	None	Home s		
1.2.2	<input checked="" type="checkbox"/>		QB-BEZ_006		Sprue Bushing			1.00	ea	0	Item	None	Product		Audio	Standar	Site	None	Home s		
1.2.3	<input checked="" type="checkbox"/>		QB-BEZ_009		Locking Ring			1.00	ea	0	Item	None	Product		Audio	Standar	Site	None	Home s		
1.2.4	<input checked="" type="checkbox"/>		QB-BEZ_004C2		Guard Pillar			5.00	ea	0	Item	None	Product		Audio	Standar	Site	None	Home s		
1.2.5	<input checked="" type="checkbox"/>		RB-HASCO-01		HASCO Metric Clamping Plate			1.00	ea	0	Item	None	Product		Audio	Standar	Site	None	Home s		
1.2.6	<input checked="" type="checkbox"/>		QB-BEZ_003		Cavity Plate A			1.00	ea	0	Item	None	Product		Audio	Standar	Site	None	Home s		
1.2.7	<input checked="" type="checkbox"/>		QB-BEZ_007		Connecting Nipple			4.00	ea	0	Item	None	Product		Audio	Standar	Site	None	Home s		
1.2.8	<input checked="" type="checkbox"/>		QB-BEZ_004		Guide Pillar			4.00	ea	0	Item	None	Product		Audio	Standar	Site	None	Home s		
1.3	<input checked="" type="checkbox"/>		QB-BEZ_008	A	Bezel Moldbase - Moving Half			1.00	ea	0	Item	BOM	Product		Audio	Standar	Site	None	Home s		
1.3.1	<input checked="" type="checkbox"/>		RB-HASCO-01		HASCO Metric Clamping Plate			1.00	ea	0	Item	None	Product		Audio	Standar	Site	None	Home s		
1.3.2	<input checked="" type="checkbox"/>		QB-BEZ_010		Guide Bushing			4.00	ea	0	Item	None	Product		Audio	Standar	Site	None	Home s		
1.3.3	<input checked="" type="checkbox"/>		QB-BEZ_009		Clamp Plate, Side Core			4.00	ea	0	Item	None	Product		Audio	Standar	Site	None	Home s		
1.3.4	<input checked="" type="checkbox"/>		QB-BEZ_010-B	B	Cavity Plate B			1.00	ea	0	Item	None	Product		Audio	Standar	Site	None	Home s		
1.3.5	<input checked="" type="checkbox"/>		RB-HASCO-02		Slide			1.00	ea	0	Item	None	Product		Audio	Standar	Site	None	Home s		
1.3.6	<input checked="" type="checkbox"/>		QB-BEZ_011		Spacer Block			2.00	ea	0	Item	None	Product		Audio	Standar	Site	None	Home s		
1.3.7	<input checked="" type="checkbox"/>		QB-BEZ_007		Connecting Nipple			4.00	ea	0	Item	None	Product		Audio	Standar	Site	None	Home s		
1.3.8	<input checked="" type="checkbox"/>		QB-BEZ_013		Center Sleeve			4.00	ea	0	Item	None	Product		Audio	Standar	Site	None	Home s		
1.4	<input checked="" type="checkbox"/>		QB-BEZ_002	A	Bezel Moldbase Side Core Slids			2.00	ea	0	Item	BOM	Product		Audio	Standar	Site	None	Home s		
1.4.1	<input checked="" type="checkbox"/>		QB-BEZ_023		Slide			1.00	ea	0	Item	None	Product		Audio	Standar	Site	None	Home s		
1.5	<input checked="" type="checkbox"/>	000283	QB-BEZ_015	A	Bezel Moldbase Ejector Set			1.00	ea	0	Item	BOM	Product	REV	Audio	Standar	Site	None	Home s		
1.5.1	<input checked="" type="checkbox"/>		QB-BEZ_021		Seating Washer			4.00	ea	0	Item	None	Product		Audio	Standar	Site	None	Home s		
1.5.2	<input checked="" type="checkbox"/>		QB-BEZ_016		Base Plate Ejector			1.00	ea	0	Item	None	Product		Audio	Standar	Site	None	Home s		
1.5.3	<input checked="" type="checkbox"/>		QB-BEZ_017		Ejector Retainer Plate			1.00	ea	0	Item	None	Product		Audio	Standar	Site	None	Home s		
1.5.4	<input checked="" type="checkbox"/>		QB-BEZ_019		Unifiter T-Gibs			2.00	ea	0	Item	None	Product		Audio	Standar	Site	None	Home s		
1.5.5	<input checked="" type="checkbox"/>		QB-BEZ_018		Ejector Pin			5.00	ea	0	Item	None	Product		Audio	Standar	Site	None	Home s		
1.5.6	<input checked="" type="checkbox"/>		Z40-4x250	A	Ejector Pin - Assy			1.00	ea	0	Item	None	Product	REV	Audio	Standar	Site	None	Home s		

Features

- Real-time, direct, two-way link with AX
- Automated, single-step BOM push
- View BOM change summary
- Push Revision to Dynamics AX and CAD
- Export Excel and PDF files
- Notification for errors and missing fields

Benefits

- Eliminate manual data entry
- Cut design cost
- Improve data consistency
- Improve information flow
- Increase data accuracy
- Reduce cycle time

+1 905 479 7811 | info@QBuildSoftware.com | +1 905 479 2636

www.QBuildSoftware.com

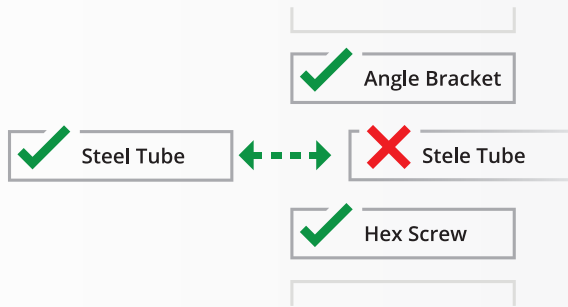

Resolve Discrepancies

Discrepancies between CAD and Dynamics AX are highlighted, allowing you to select or enter the correct



Access MS Dynamics AX Data

CADLink's direct integration allows you to access AX data such as Product Code, Part Class, and Raw Material Part Data from the CADLink interface.

Operations

Assigning Dynamics Operations is easy!
Simply select a work center from a drop-down list.

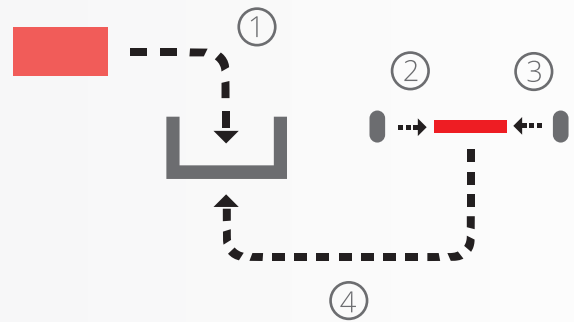

Partners & Integrations

