

CADLink

Real time BOM comparison, 2-way data push
Payback period of 6 months

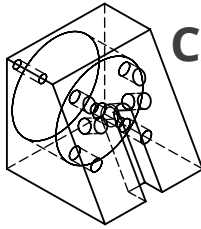

CAD



No	Save	ITEM	Description	Revision	U/M	Qty	Product Code	Source	Stocked	Phantom	Matl Type	BOM Changes
1		23-99927	desc	B	EA	1.0000	FG-100	M			M	
1.1		23-00282	COIL STEEL A715-80 3/16	D	EA	1.0000	FG-100	P			M	
1.2		23-00283	ANGLE 2-1/2 x 2-1/2 x 3/16 x 20	C	EA	1.0000	FG-100	P			M	
1.3		23-00285	COIL STEEL A715-80 1/4	B	EA	1.0000	FG-100	P			M	
1.4		23-00381	COIL STEEL A715-80 1/4	B	EA	2.0000	FG-100	P			M	
1.5		23-01013	AIR CAN MOUNT ASSY; AIR SLIDE TONGU	B	EA	2.0000	FG-100	M			M	
1.5.1		23-01014	MNT PLT; AIR CAN; RECEIVER; SLIDE T	000	EA	1.0000	FG-100	P			M	
1.5.2		23-01016	BOLT; MOUNT; AIR CAN MOUNT ASSY	D	EA	2.0000	FG-100	P			M	
1.5.3		23-01015	BLK PIPE SCH 80, 3/4 x 4	C	EA	2.0000	FG-100	P			M	
1.5.4		10026A	NUT LOCK ALL METAL 5/8 UNF	F	EA	2.0000	FG-100	P			M	
1.6		23-01157	BLK PIPE 80 PE 3/4 x 211	A	EA	2.0000	FG-100	P			M	
1.7		23-01158	COIL STEEL A715-80 3/8	A	EA	2.0000	FG-100	P			M	
1.8		23-01159	COIL STEEL 123456789	D	EA	2.0000	FG-100	P			M	
1.9		23-01160T	COIL STEEL A715-80 1/4	E	EA	2.0000	FG-100	P			M	
1.10		23-01421-001	ANGLE 2-1/2 x 2-1/2 x 3/16 x 20	A	EA	1.0000	FG-100	P			M	
1.11		23-99917	DRAWBAR HOUSING ADJ 4 CASTING	C	EA	1.0000	FG-100	M			M	
1.11.1		23-99970		E	EA	1.0000	FG-100	P			M	
1.12		10026AA		A	EA	1.0000	FG-100	M			M	
1.12.1		10026A		B	EA	1.0000	FG-100	P			M	
1.12.2		10026A	NUT	A	EA	1.0000	FG-100	P			M	
1.12.3		10026A	PN	A	EA	1.0000	FG-100	P			M	
1.13		12900025	Prevailing Torque Type	000	EA	1.0000	FG-100	P			M	
1.14		GRK58	Prevailing Torque Type	000	EA	2.0000	FG-100	P			M	
1.15		RK65010		000	EA	1.0000	FG-100	M			M	
1.15.1		RK-65010		EA	1.0000	FG-100	M				M	
1.15.1.1		RK-65010-SPRING		EA	1.0000	FG-100	P				M	
1.15.1.2		RK-65010-BRACKET		EA	1.0000	FG-100	P				M	
1.15.1.3		RK-65010-PIN		EA	1.0000	FG-100	P				M	
1.16		XA-0372-A-001		D	EA	1.0000	FG-100	P			M	
1.17		SD-12000	Gears,12-Speed	EA	0.0000	PP	P				M	

Item	CAD	CAD	ERP	CAD	ERP	Notes
23-99927						
23-00283	1	1	0	10	0	Insert to BOM
23-00381	2	2	0	10	0	Insert to BOM
23-01013	2	2	0	10	0	Create new Item and inser...
23-01157	2	2	0	10	0	Insert to BOM
23-01158	2	2	0	10	0	Insert to BOM
23-01159	2	2	0	10	0	Insert to BOM
23-0116...	2	2	0	10	0	Create new Item and inser...
23-0142...	1	1	0	10	0	Create new Item and inser...
23-99917	1	1	0	10	0	Create new Item and inser...
10026AA	1	1	0	10	0	Create new Item and inser...
1292000...	1	1	0	10	0	Create new Item and inser...
GRK58	2	2	0	10	0	Insert to BOM
RK65010	1	1	0	10	0	Create new Item and inser...
KA-637...	1	1	0	10	0	Create new Item and inser...
23-01013						
23-01014	1	1	0	10	0	Create new Item and inser...
23-01016	2	2	0	10	0	Create new Item and inser...
23-01015	2	2	0	10	0	Create new Item and inser...
10026A...	2	2	0	10	0	Create new Item and inser...
23-99917						
23-99970	1	1	0	10	0	Create new Item and inser...
10026AA						
10026A...	1	1	0	10	0	Create new Item and inser...
RK65010						
RK-65010	1	1	0	10	0	Create new Item and inser...
RK-65010						

Features

- Real-time, direct, two-way link with Infor
- Automated, single-step BOM push
- View BOM change summary
- Push Revision to Infor and CAD
- Export Excel and PDF files
- Notification for errors and missing fields

Benefits

- Eliminate manual data entry
- Cut design cost
- Improve data consistency
- Improve information flow
- Increase data accuracy
- Reduce cycle time



Solution
Partner

www.QBuildSoftware.com

✉ info@QBuildSoftware.com

☎ +1 905 479 7811

☎ +1 905 479 2636

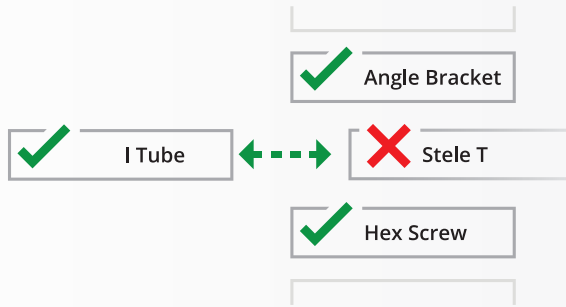

Resolve Discrepancies

Discrepancies between CAD and Infor are highlighted, allowing you to select or enter the correct data.

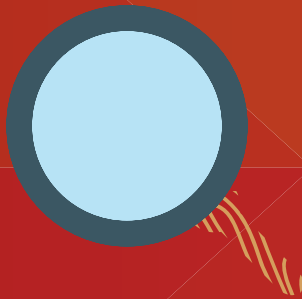

Access Infor Data

CADLink's direct integration allows you to access Infor data such as Product Code, Part Class, and Raw Material Part Data from the CADLink interface.

Operations

Assigning Infor Operations is easy! Simply select a work center from a drop-down list.

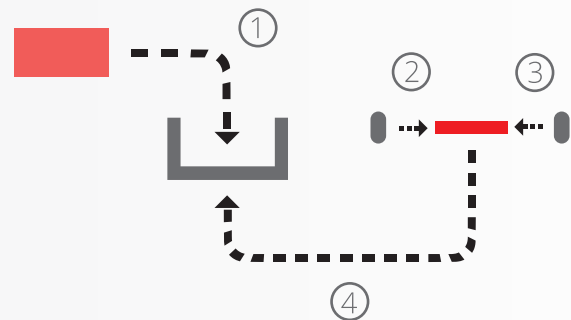

Partners & Integrations

