

CADLink

Real time BOM comparison, 2-way data push
Payback period of 6 months

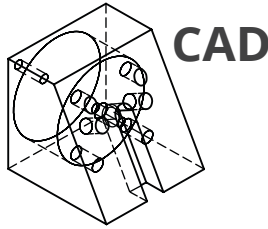

eci™

M1®

CADLink 5.96.0.0

Search by PartNumber/Description:

Save Refresh Settings Manual Export Operations Changes CAD Data Messages Toggle

No	Save	Part Number	Revision	Part Description	Related Operation	Unit Qty	Uom	Part Group	Part Class	Part Type	MI Related Operation	MI Part Number
1		TM00739	000	SH100 - S - M - ASSEMBLY	0	1,0000	EA	Tooling	Hardware	Manufactured		
1.1		TM00745	000	SH100 - S - M - FRAME	0	1,0000	EA	Automotive	Hardware	Purchased		
1.2		TM00749	000	SH100 - S - M - BEARING PAD	0	8,0000	EA	Automotive	Hardware	Purchased		
1.3		TM00740	000	SH100 - S - M - SIDE COVER	0	2,0000	EA	Automotive	Hardware	Purchased		
1.4		TM00742	000	SH100 - S - M - HINGE MALE	0	2,0000	EA	Automotive	Hardware	Purchased		
1.5		TM00762	000	SH100 - S - M - 350 - 2550	0	8,0000	EA	Tooling	Sheet Metal	Purchased		
1.6		TM00755	000	SH100 - S - M - INSIDE COVER	0	2,0000	EA	Automotive	Hardware	Purchased		
1.7		TM00763	000	SH100 - S - M - NO CAMERA 34 SIDE PLATE	0	1,0000	EA	Tooling	Hardware	Purchased		
1.8		TM00766	000	SH100 - S - M - NO CAMERA 12 SIDE PLATE	0	1,0000	EA	Tooling	Hardware	Purchased		
1.9		TM00746	000	SH100 - S - M - CAMERA 34 SIDE PLATE	0	1,0000	EA	Tooling	Hardware	Purchased		
1.10		TM00788	000	SH100 - S - M - CAMERA 12 SIDE PLATE	0	1,0000	EA	Tooling	Hardware	Purchased		
1.11		TM00989	000	SH100 - S - M - CAMERA SLIDE ASSEMBLY	0	4,0000	EA	Automotive	Hardware	Manufactured		
1.11.1		TM00970	000	SH100 - M - CAMERA BRACKET BASE	10	1,0000	EA	Automotive	Hardware	Purchased		
1.11.2		TM00989	000	SH100 - M - CAMERA BRACKET TOP	20	1,0000	EA	Tooling	Manufactured			
1.11.3		DALS-A CAMERA			0	1,0000	EA	Automotive	Hardware	Purchased		
1.11.4		SD000044	000	CAMERA LOCK CLAMPING KNOB	0	1,0000	EA	Automotive	Hardware	Purchased		
1.11.5		PV01158	001	VWGM - 01 - 08	10	4,0000	EA	Tooling	Hardware	Purchased	0	090-258-0820
1.11.6		PV01157	001	VWGM - 08	0	2,0000	EA	Tooling	Hardware	Purchased		
1.12		SD000262	000	Mounting Bracket for FA-240	0	2,0000	EA	Automotive	Hardware	Purchased		
1.13		SD000281	000	6" Stroke 200 lbs Force Linear Actuator	0	1,0000	EA	Automotive	Hardware	Purchased		
1.14		TM00779	000	SL LED ASSEMBLY	0	16,0000	EA	Automotive	Hardware	Manufactured		
1.14.1		SD000192	000	Cool White Rebel LEDs, 20mm Tri-Star CoolBase	0	1,0000	EA	Automotive	Hardware	Purchased		
1.14.2		SD000158	000	Carco 2" Frosted Tri-LED Optic	0	1,0000	EA	Automotive	Hardware	Purchased		
1.14.3		TM00559	000	SL LED PLASTIC COVER	10	1,0000	EA	Automotive	Hardware	Manufactured	0	105-ITEM10
1.14.4		TM00564	000	SL LED BASE #5	10	1,0000	EA	Automotive	Hardware	Purchased		
1.15		SD000095	000	SH100 - GAS SPRING	0	2,0000	EA	Tooling	Hardware	Manufactured		
1.15.1		TM00751	000	GAS SPRING SIDE 2	20	1,0000	EA	Automotive	Hardware	Purchased		
1.15.2		TM00752	000	GAS SPRING SIDE 1	0	1,0000	EA	Automotive	Hardware	Purchased		
1.15.3		TM00750	000	GAS SPRING ROD	0	1,0000	EA	Tooling	Hardware	Purchased		
1.16			000	GAS STRUT STAND OFF	0	4,0000	EA	Automotive	Hardware	Purchased		
1.17		TM00754	000	SW1 BALL STUD	0	4,0000	EA	Tooling	Hardware	Purchased	0	105-ITEM6
1.18		TM00743	000	SH100 - S - M - HINGE FEMALE	0	2,0000	EA	Automotive	Hardware	Purchased		
1.19		TM00741	000	SH100 - S - M - HINGE SPACER	0	2,0000	EA	Automotive	Hardware	Purchased		
1.20		TM00744	000	SH100 - S - M - TOP COVER	0	2,0000	EA	Tooling	Manufactured	0	105-ITEM8	
1.21		TM00756	000	SH100 - S - M - BUSHING	0	2,0000	EA	Automotive	Hardware	Purchased		
1.22		TM00773	000	NAME PLATE	0	1,0000	EA	Automotive	Hardware	Purchased		
1.23		TM00772	000	SH100 - S - M - BOTTOM COVER	0	2,0000	EA	Automotive	Hardware	Purchased		
1.24		TM00769	000	SH100 - S - M - DOWEL PIN	0	2,0000	EA	Automotive	Hardware	Purchased		

M1 Server: 192.168.1.6\MISERVER M1 Database: M1_M1 CAD System: SolidWorks

Features

- Real-time, direct, two-way link with M1
- Automated, single-step BOM push
- View BOM change summary
- Push Revision to ECI M1 and CAD
- Export Excel and PDF files
- Notification for errors and missing fields

Benefits

- Eliminate manual data entry
- Cut design cost
- Improve data consistency
- Improve information flow
- Increase data accuracy
- Reduce cycle time

+1 905 479 7811 | info@QBuildSoftware.com | +1 905 479 2636

www.QBuildSoftware.com

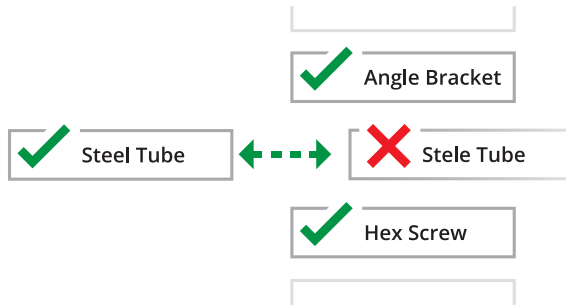

Resolve Discrepancies

Discrepancies between CAD and ECI M1 are highlighted, allowing you to select or enter the correct data.



Access ECI M1 Data

CADLink's direct integration allows you to access M1 data such as Product Code, Part Class, and Raw Material Part Data from the CADLink interface.

Operations

Assigning M1 Operations is easy! Simply select a work center from a drop-down list.

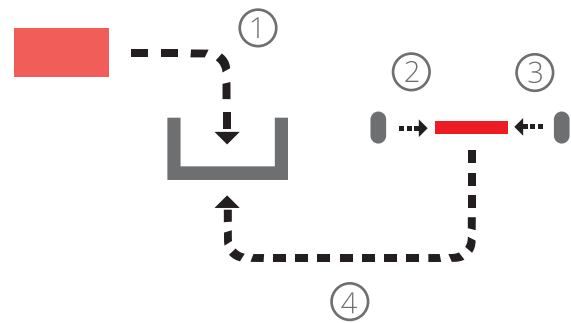

Partners & Integrations

Work with CAD/PLM/PDM of your choice

