

# CADLink

Real time BOM comparison, 2-way data push  
Payback period of 6 months

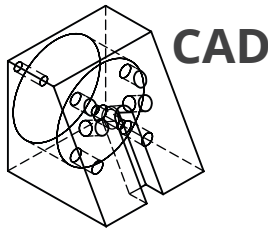

EPICOR

CADLink 5.204.0.0

Search by Part Number/Description...

SAVE REFRESH SETTINGS

New Delete Manual

EXPORT OPERATIONS CHANGES IMPACT CAD DATA MESSAGES TOGGLE

No	Save	Part Number	Revision	Part Description	Related Operation	Unit Qty	Ref Designators	Item Class	Inventory Item	Product Group	Part Class	Part Type	Mtl Relat
1		MC-00129ASM-01	A	4 Digit Mechanical Counter Assembly	0	1,000		Counted Units	Each		Hardware	Manufactured	
1.1		Mechanical Stem Assembly	A	Mechanical Advance Assembly	0	1,000		Counted Units	Each	Configured Parts	Hardware	Manufactured	
1.1.1		AL-00132ASM	A	Advance Latch Assembly	0	1,000		Counted Units	Each	Fabricated	Machined Parts	Manufactured	
1.1.1.1		AL-400291	2	Advance Latch, 4 Digit	0	1,000		Counted Units	Each			Purchased	0
1.1.1.2		SS-0012834	5	Spring, Steel Mtl 12834	0	1,000		Counted Units	Each			Manufactured	
1.1.2		ALH-08123ASM	A	Advance Latch Housing Assembly	0	1,000		Counted Units	Each	Pneumatic Parts	Hardware	Manufactured	
1.1.2.1		ASS-029311-001	1	Advance Spring Stud Black	0	2,000		Counted Units	Each	Pneumatic Parts	Hardware	Purchased	
1.1.2.2		AL-192312	3	Advance Spring Stud Black	0	1,000		Counted Units	Each	Pneumatic Parts	Hardware	Purchased	
1.1.2.3		ALH-4002917	4	Advance Latch Housing 4 Digit	0	1,000		Counted Units	Each	Pneumatic Parts	FG-Fabricated	Purchased	
1.1.2.4		AP-0028434	6	Advance Pin, Steel Material 28434	0	1,000		Counted Units	Each	Pneumatic Parts	Electrical Part	Manufactured	
1.1.2.5		RB-0918075	3	Reset Bearing	0	1,000		Counted Units	Each	Fabricated	Machined Parts	Purchased	
1.1.2.6		ASS-029311	A	Advance Spring Stud Black	0	2,000		Counted Units	Each	Pneumatic Parts	Hardware	Purchased	
1.2		CR-39102ASM	A	Counter Reset Assembly	0	1,000		Counted Units	Each	Configured Parts	Hardware	Manufactured	
1.2.1		LATCH 1	4	Counter Reset Latch	0	4,000		Counted Units	Each	Configured Parts	Hardware	Purchased	
1.2.2		RS-0019234-01	2	Reset Spring, Steel Material 1923	0	4,000		Counted Units	Each	Configured Parts	Hardware	Purchased	
1.2.3		TAYGB-LS-62384	3	Reset Latch Shaft	0	1,000		Counted Units	Each			Purchased	
1.3		NWA-01231ASM	A	Numbering Wheel 4 Digits Assembly	0	1,000		Counted Units	Each	Pneumatic Parts	FG-Configured	Manufactured	
1.3.1		PN-001399	3	PN, Material 1399	0	2,000		Counted Units	Each	Pneumatic Parts	Hardware	Purchased	
1.3.2		MNS-023912	3	Numbering Wheel Shaft	0	1,000		Counted Units	Each	Pneumatic Parts	Pneumatic Parts/Comp	Purchased	
1.3.3		RNG-18920	4	Reset Worm Gear	0	1,000		Counted Units	Each	Pneumatic Parts	Hardware	Purchased	
1.3.4		RP-0011789	5	Reset Pin, Material 1789	0	1,000		Counted Units	Each	Pneumatic Parts	Pneumatic Parts/Comp	Purchased	
1.3.5		NM-4-8975	2	Numbering Wheel Counter	0	1,000		Counted Units	Each	Pneumatic Parts	Hardware	Purchased	
1.3.6		Tread Block 1	4	Advance Latch	0	4,000		Counted Units	Each	Pneumatic Parts	Hardware	Manufactured	
1.4		NW-17382ASM	A	Numbering Wheel Housing Assembly	0	1,000		Counted Units	Each	Fabricated	Hardware	Manufactured	
1.4.1		SB-0293121		Print Head Spring Bracket, Material 9231	10	1,000		Counted Units	Each	Powertrain Parts/Comp	FG-Configured	Purchased	
1.4.2		ASS-029311-001	1	Advance Spring Stud Black	0	2,000		Counted Units	Each	Pneumatic Parts	Hardware	Purchased	
1.4.3		RS-007535	2	Reset Spacer	0	1,000		Counted Units	Each			Purchased	
1.4.4		MCH-M00932	4	4 Digit Mechanical Counter Housing	10	1,000		Counted Units	Each	Pneumatic Parts	Hardware	Purchased	
1.4.5		CH-0219200	2	Carriage Header1	10	4,000		Counted Units	Each	Pneumatic Parts	Hardware	Purchased	
1.4.6		ASS-029311	A	Advance Spring Stud Black	10	2,000		Counted Units	Each	Pneumatic Parts	Hardware	Purchased	
1.4.7		200604-000	A	ASSEMBLY, BREAKER, IT-AB #RUT BRKR	10	1,000		Counted Units	Each	Fabricated	Machined Parts	Purchased	
1.5		PRINT HEAD ADVANCE SPRING		Counter Advance Spring	0	2,000		Counted Units	Each	Configured Parts	Hardware	Purch	
1.6		GB-x123	A	Mechanical Advance Assembly	0	1,000		Counted Units	Each	Configured Parts	Hardware	Manuf	

Connected to CAD: SolidWorks Connected to BOM Type: StdBom App Url: net.tcp://WIN-SRQ6LP1CK/ERP101400

## Features

- Real-time, direct, two-way link with Epicor
- Automated, single-step BOM push
- View BOM change summary
- Push Revision to Epicor and CAD
- Export Excel and PDF files
- Notification for errors and missing fields

## Benefits

- Eliminate manual data entry
- Cut design cost
- Improve data consistency
- Improve information flow
- Increase data accuracy
- Reduce cycle time

+1 905 479 7811 | info@QBuildSoftware.com | +1 905 479 2636

www.QBuildSoftware.com

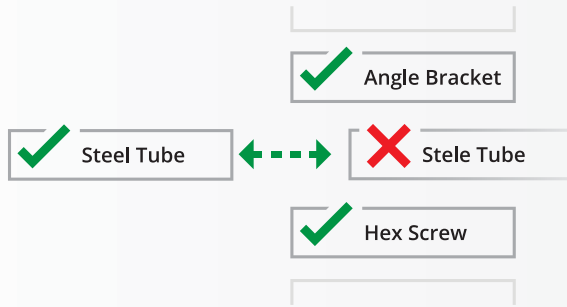

## Resolve Discrepancies

Discrepancies between CAD and Epicor are highlighted, allowing you to select or enter the correct data.



## Access Epicor Data

CADLink's direct integration allows you to access Epicor data such as Product Code, Part Class, and Raw Material Part Data from the CADLink interface.

## Operations

Assigning Epicor Operations is easy! Simply select a work center from a drop-down list.

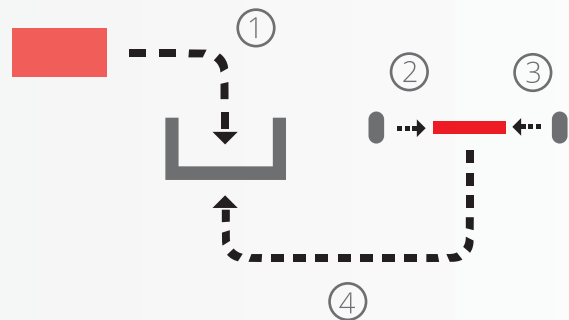

**Partners**  
& Integrations



cabinet vision

