

# CADLink

Real time BOM comparison, 2-way data push  
Payback period of 6 months

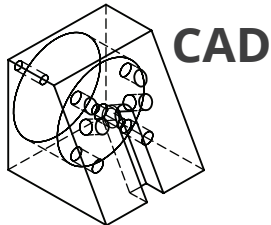

CADLink 1.0.6.1

Save Refresh CADLink Settings

Search by part number  Only show new parts Show All

Search by part description  Only show to be deleted bom components

Export - EXCEL Export - PDF Expand All Collapse All Close

Bill of Materials

No	Save	Part Number	Revision	Part Description	Related Operation	Unit Qty	Uom	Part Group	Part Class	Part Type	MI Related Operation	MI Part No
1.1	<input checked="" type="checkbox"/>	TM00739	000	SH100 - 5 - M - ASSEMBLY	0	1,0000	EA	Tooling	Hardware	Manufactured		
1.2	<input checked="" type="checkbox"/>	TM00745	000	SH100 - 5 - M - FRAME	0	1,0000	EA	Tooling	Hardware	Purchased		
1.3	<input checked="" type="checkbox"/>	TM00749	000	SH100 - 5 - M - BEARING PAD	0	6,0000	EA	Tooling	Hardware	Purchased		
1.4	<input checked="" type="checkbox"/>	TM00740	000	SH100 - 5 - M - SIDE COVER	0	2,0000	EA	Tooling	Hardware	Purchased		
1.5	<input checked="" type="checkbox"/>	TM00742	000	SH100 - 5 - M - HINGE MALE	0	2,0000	EA	Tooling	Hardware	Purchased		
1.6	<input checked="" type="checkbox"/>	TM00743	000	SH100 - 5 - M - HINGE FEMALE	0	2,0000	EA	Tooling	Hardware	Purchased		
1.7	<input checked="" type="checkbox"/>	TM00741	000	SH100 - 5 - M - HINGE SPACER	0	2,0000	EA	Tooling	Hardware	Purchased		
1.8	<input checked="" type="checkbox"/>	TM00744	000	SH100 - 5 - M - TOP COVER	0	2,0000	EA	Tooling	Hardware	Purchased		
1.9	<input checked="" type="checkbox"/>	TM00767	000	SH100 - 5 - M - 330 - 2550	0	1,0000	EA	Tooling	Hardware	Purchased		
1.10	<input checked="" type="checkbox"/>	TM00762	000	SH100 - 5 - M - 350 - 2550	0	6,0000	EA	Tooling	Hardware	Purchased		
1.11	<input checked="" type="checkbox"/>	TM00761	000	SH100 - 5 - M - 310 - 2550	0	1,0000	EA	Tooling	Hardware	Purchased		
1.12	<input checked="" type="checkbox"/>	TM00755	000	SH100 - 5 - M - INSIDE COVER	0	2,0000	EA	Tooling	Hardware	Purchased		
1.13	<input checked="" type="checkbox"/>	TM00763	000	SH100 - 5 - M - NO CAMERA 34 SIDE PLATE	0	1,0000	EA	Tooling	Hardware	Purchased		
1.14	<input checked="" type="checkbox"/>	TM00766	000	SH100 - 5 - M - NO CAMERA 12 SIDE PLATE	0	1,0000	EA	Tooling	Hardware	Purchased		
1.15	<input checked="" type="checkbox"/>	TM00746	000	SH100 - 5 - M - CAMERA 34 SIDE PLATE	0	1,0000	EA	Tooling	Hardware	Purchased		
1.16	<input checked="" type="checkbox"/>	TM00758	000	SH100 - 5 - M - CAMERA 12 SIDE PLATE	0	1,0000	EA	Tooling	Hardware	Purchased		
1.17	<input checked="" type="checkbox"/>	TM00773	000	NAME PLATE	0	1,0000	EA	Tooling	Hardware	Purchased		
1.18	<input checked="" type="checkbox"/>	TM00772	000	SH100 - 5 - M - BOTTOM COVER	0	2,0000	EA	Tooling	Hardware	Purchased		
1.19	<input checked="" type="checkbox"/>	TM00769	000	SH100 - 5 - M - DOVREL RN	0	2,0000	EA	Tooling	Hardware	Purchased		
1.20	<input checked="" type="checkbox"/>	RD00132	000	323 CLAMP PULL-ACTION	0	1,0000	EA	Tooling	Hardware	Purchased		
1.21	<input checked="" type="checkbox"/>	TM00968	000	SH100 - 5 - M - CAMERA SLICE ASSEMBLY	0	4,0000	EA	Tooling	Hardware	Manufactured		
1.2	<input checked="" type="checkbox"/>	PV01157	001	WSQ - 06	0	2,0000	EA	Tooling	Hardware	Purchased		
1.2	<input checked="" type="checkbox"/>	TM00970	000	SH100 - M - CAMERA BRACKET BASE	0	1,0000	EA	Tooling	Hardware	Purchased		
1.2	<input checked="" type="checkbox"/>	TM00969	000	SH100 - M - CAMERA BRACKET TOP	0	1,0000	EA	Tooling	Hardware	Purchased		
1.2	<input checked="" type="checkbox"/>	DALSA CAMERA			0	1,0000	EA	Tooling	Hardware	Purchased		
1.2	<input checked="" type="checkbox"/>	SD000944	000	CAMERA LOCK CLAMPING KNOB	0	1,0000	EA	Tooling	Hardware	Purchased		
1.2	<input checked="" type="checkbox"/>	PV01158	001	WJQM - 01 - 06	0	4,0000	EA	Tooling	Hardware	Purchased		
1.2	<input checked="" type="checkbox"/>	HKX-0412		HEX HD BOLT	0	14,0000	EA	Tooling	Finished Goods	Purchased		
1.22	<input checked="" type="checkbox"/>	SD000262	000	Mounting Bracket for FA-240	0	2,0000	EA	Tooling	Hardware	Purchased		
1.23	<input checked="" type="checkbox"/>	SD000261	000	6" Stroke 200 lbs Force Linear Actuator	0	1,0000	EA	Tooling	Hardware	Purchased		
1.24	<input checked="" type="checkbox"/>	TM00719	000	S LED 5 ASSEMBLY	0	18,0000	EA	Tooling	Hardware	Manufactured		
1.25	<input checked="" type="checkbox"/>	SD000095	000	SH100 - GAS SPRING	0	2,0000	EA	Tooling	Hardware	Manufactured		
1.2	<input checked="" type="checkbox"/>	TM00751	000	GAS SPRING SIDE 2	0	1,0000	EA	Tooling	Hardware	Purchased		
1.2	<input checked="" type="checkbox"/>	TM00752	000	GAS SPRING SIDE 1	0	1,0000	EA	Tooling	Hardware	Purchased		
1.2	<input checked="" type="checkbox"/>	TM00750	000	GAS SPRING ROD	0	1,0000	EA	Tooling	Hardware	Purchased		
1.26	<input checked="" type="checkbox"/>	GAS STRUT STAND OFF		GAS STRUT STAND OFF	0	4,0000	EA	Tooling	Hardware	Purchased		
1.27	<input checked="" type="checkbox"/>	TM00754	000	SW11 BALL STUD	0	4,0000	EA	Tooling	Hardware	Purchased		
1.28	<input checked="" type="checkbox"/>	HKX-0360		HEX HD BOLT	0	20,0000	EA	Tooling	Finished Goods	Purchased		

## Features

- Real-time, direct, two-way link with M1
- Automated, single-step BOM push
- View BOM change summary
- Push Revision to ECI M1 and CAD
- Export Excel and PDF files
- Notification for errors and missing fields

## Benefits

- Eliminate manual data entry
- Cut design cost
- Improve data consistency
- Improve information flow
- Increase data accuracy
- Reduce cycle time

+1 905 479 7811 | info@QBuildSoftware.com | +1 905 479 2636

www.QBuildSoftware.com

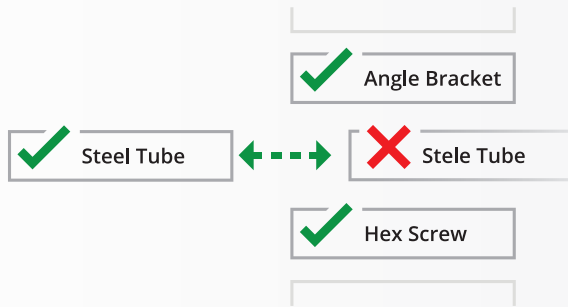

## Resolve Discrepancies

Discrepancies between CAD and ECi M1 are highlighted, allowing you to select or enter the correct data.



## Access ECi M1 Data

CADLink's direct integration allows you to access M1 data such as Product Code, Part Class, and Raw Material Part Data from the CADLink interface.

## Operations

Assigning M1 Operations is easy! Simply select a work center from a drop-down list.

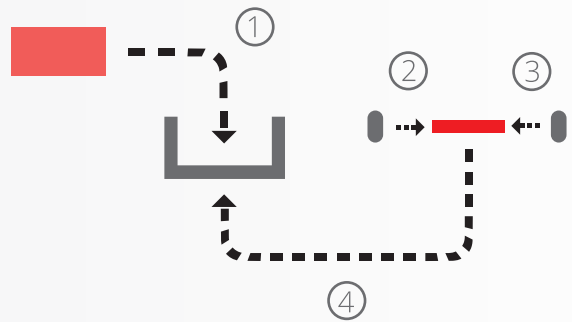

## Partners & Integrations

