

CADLink

Real time BOM comparison, 2-way data push
Payback period of 6 months

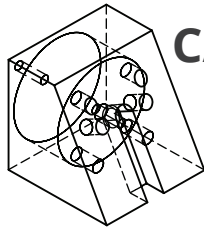

CAD

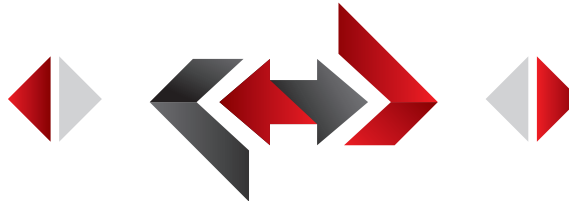

CADLink (Ver: V2.0 Build: 80190)

Save Refresh

Expand All Collapse All Exit

No	Save	ITEM	Description	Revision	UOM	Oper num	Qty	Product Code	Source	Stocked	Mult Type	ABC Code	Cost Method	Coat Type	MFI
1	<input checked="" type="checkbox"/>	QB-BEZ_001	Bezel Mdbase	A	EA		1,000	FG-CUSTOM	M	<input type="checkbox"/>	M	A	S	A	
1.1	<input checked="" type="checkbox"/>	QB-BEZ_002	Bezel Mdbase - Fixed Half	A	EA		1,000	FG-CUSTOM	M	<input type="checkbox"/>	M	A	S	A	
1.1.1	<input checked="" type="checkbox"/>	QB-BEZ_003	Cavity Plate A				1,000			<input type="checkbox"/>					
1.1.2	<input checked="" type="checkbox"/>	RB-HASCO-01	HASCO Metric Clamping Plate		EA		1,000	FG-200	P	<input type="checkbox"/>	M	C	S	A	
1.1.3	<input checked="" type="checkbox"/>	RB-HASCO-03	HASCO Metric Angle Pin				4,000	FG-CUSTOM	P	<input type="checkbox"/>	T	B	S	A	
1.1.4	<input checked="" type="checkbox"/>	QB-BEZ_004	Guide Piler		EA		4,000	FG-CUSTOM	P	<input type="checkbox"/>	O	B	S	A	
1.1.5	<input checked="" type="checkbox"/>	QB-BEZ_005	Loading Ring		EA		1,000	FG-100	P	<input checked="" type="checkbox"/>	O	B	S	A	
1.1.6	<input checked="" type="checkbox"/>	QB-BEZ_006	Spline Bushing				1,000			<input type="checkbox"/>					
1.1.7	<input checked="" type="checkbox"/>	QB-BEZ_007-01A	Connecting Nipple				4,000			<input type="checkbox"/>					
1.2	<input checked="" type="checkbox"/>	QB-BEZ_008	Bezel Mdbase - Moving Half	A	EA	10	1,000	FG-CUSTOM	M	<input type="checkbox"/>	M	A	S	A	
1.2.1	<input checked="" type="checkbox"/>	QB-BEZ_009	Side Core Clamp Plate				4,000			<input type="checkbox"/>					
1.2.2	<input checked="" type="checkbox"/>	QB-BEZ_010	Cavity Plate B	A	EA	10	1,000	FG-CUSTOM	P	<input type="checkbox"/>	M	B	S	A	
1.2.3	<input checked="" type="checkbox"/>	RB-HASCO-02	HASCO Metric Intermediate Plate		EA	10	1,000	FG-200	P	<input type="checkbox"/>	M	C	S	A	
1.2.4	<input checked="" type="checkbox"/>	QB-BEZ_011-B	Spacer Block				2,000			<input type="checkbox"/>					
1.2.5	<input checked="" type="checkbox"/>	RB-HASCO-01	HASCO Metric Clamping Plate		EA	10	1,000	FG-200	P	<input type="checkbox"/>	M	C	S	A	
1.2.6	<input checked="" type="checkbox"/>	QB-BEZ_012	Guide Bushing				4,000			<input type="checkbox"/>					
1.2.7	<input checked="" type="checkbox"/>	QB-BEZ_013	Centering Sleeve				4,000			<input type="checkbox"/>					
1.2.8	<input checked="" type="checkbox"/>	QB-BEZ_007-01A	Connecting Nipple				4,000			<input type="checkbox"/>					
1.2.9	<input checked="" type="checkbox"/>	QB-BEZ_011	Spacer Block		EA	10	2,000	FG-CUSTOM	P	<input type="checkbox"/>	M	B	S	A	
1.3	<input checked="" type="checkbox"/>	QB-BEZ_015	Bezel Mdbase Ejector Set	A	EA		1,000	FG-CUSTOM	M	<input type="checkbox"/>	M	A	S	A	
1.3.1	<input checked="" type="checkbox"/>	QB-BEZ_019	Ejector Pin				5,000			<input type="checkbox"/>					
1.3.2	<input checked="" type="checkbox"/>	QB-BEZ_018	Unlifter T-Stub		EA		2,000	FG-CUSTOM	P	<input type="checkbox"/>	M	B	S	A	
1.3.3	<input checked="" type="checkbox"/>	QB-BEZ_021	Seating Washer		EA		4,000	FG-CUSTOM	P	<input checked="" type="checkbox"/>	T	B	S	A	
1.3.4	<input checked="" type="checkbox"/>	Z40-4-250	Ejector Pin - Assy	A			1,000			<input type="checkbox"/>					
1.3.5	<input checked="" type="checkbox"/>	QB-BEZ_016	Ejector Base Plate	B	EA		1,000	FG-CUSTOM	P	<input type="checkbox"/>	M	B	S	A	
1.3.6	<input checked="" type="checkbox"/>	QB-BEZ_017	Ejector Retainer Plate	B	EA		1,000	FG-CUSTOM	P	<input type="checkbox"/>	M	B	S	A	
1.4	<input checked="" type="checkbox"/>	QB-BEZ_022	Bezel Mdbase Side Core Slide	A	EA		2,000	FG-CUSTOM	M	<input type="checkbox"/>	M	A	S	A	
1.4.1	<input checked="" type="checkbox"/>	QB-BEZ_023	Slide				1,000			<input type="checkbox"/>					
1.5	<input checked="" type="checkbox"/>	QB-BEZ_024	Bezel Mdbase Lifter	A	EA		2,000	FG-CUSTOM	M	<input type="checkbox"/>	M	A	S	A	
1.5.1	<input checked="" type="checkbox"/>	QB-BEZ_025	Unlifter U-Coupling				1,000			<input type="checkbox"/>					

UserName: sa Connected To: KEVIN-HPVKEVIN_HP DataBase: SL803Demo_App

Features

- Real-time, direct, two-way link with Infor
- Automated, single-step BOM push
- View BOM change summary
- Push Revision to Infor and CAD
- Export Excel and PDF files
- Notification for errors and missing fields

Benefits

- Eliminate manual data entry
- Cut design cost
- Improve data consistency
- Improve information flow
- Increase data accuracy
- Reduce cycle time

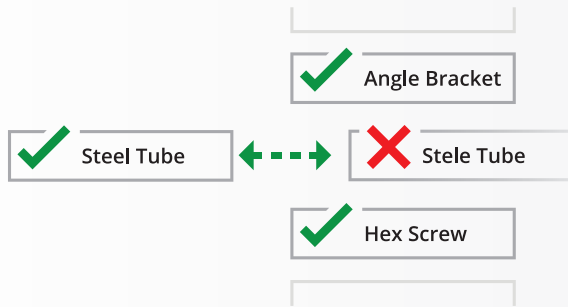

Resolve Discrepancies

Discrepancies between CAD and Infor are highlighted, allowing you to select or enter the correct data.



Access Infor Data

CADLink's direct integration allows you to access Infor data such as Product Code, Part Class, and Raw Material Part Data from the CADLink interface.

Operations

Assigning Infor Operations is easy! Simply select a work center from a drop-down list.

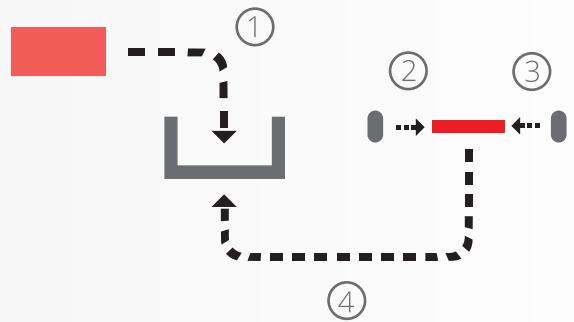

Partners & Integrations

