

Integrate CAD Data with your ERP

www.qbuildsoftware.com

QBuild Corporation designs CAD ERP data integration software to increase engineering productivity and created consistency between both systems.

CADLink interface system is a turnkey system designed to tightly connect your design information to your ERP. It allows engineering designers to view, modify, update and create ERP engineering information such as bill of materials and item master data without ever leaving the design suite of their choice:

- **AutoCAD**
- **CATIA**
- **Inventor**
- **Pro-E**
- **SolidEdge**
- **SolidWorks**

CADLink saves significant Engineering resources: Typical payback is four to six months. Production benefits from having drawing information identical to work order

ERP



CAD System

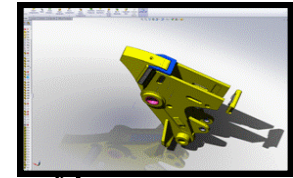

Engineering Change Management

CADLink creates the building blocks that will allow you to automate and integrate your entire revision and Engineering Change Order Process. The ECN Manager module bolts onto CADLink providing engineers with critical change information such as inventory, open work order and sales orders as engineering changes are made. This allows your engineering team to make informed decisions regarding stock disposition and inventory rework requirements.

Solution Products

CADLink	CAD Interface system that connects your design information to your ERP.
ECN Manager	Ties your ERP CAD information with your Engineering change process.
PartSurfer	Simple, read-only part search application.
Time Sheet	Tracks engineering time to properly calculate actual cost.

QBuild Software

145 Renfrew Drive
Unit 140
Markham, Ontario
Canada

Phone: 1 905-479-7811 ext 24

Fax: 1 905-479-2636

E-mail: info@qbuildsoftware.com